

Classic Ortho

Baader-No.	¹ FL (mm)	Eyepiece Type	Barrel (in.)	² E / G	³ AF	⁴ G	⁵ ER (mm)	Field Stop (mm)	⁷ Eyepiece Dimensions (mm)						Weight (g/lb/oz)
									A	B	C	D	E	F	
2954106	6	Classic Ortho	1¼"	4 / 2	52°	yes	5	5	10,20	24,00	-	34,80	-	2,00	37g
2954110	10	Classic Ortho	1¼"	4/2	52°	yes	8	8,7	17,12	24,00	-	34,80	-	2,00	48g
2954118	18	Classic Ortho	1¼"	4/2	52°	yes	14,7	16,8	30,46	24,00	-	34,80	-	2,00	81g
2954132	32	Classic Plössl	1¼"	4/2	50°	yes	21	26	54,80	24,00	-	34,80	-	2,00	94g

Table Notes

¹FL: Focal Length

²E / G: # Lens Elements / # Groups

³AF: Apparent Field of View

⁴G: Parfocal

⁵ER: Eye Relief

⁷Eyepiece Dimensions: see diagram

A: Height of barrel above reference surface

B: Height of 1¼" barrel

C: Height of 2" barrel

D: Outer Diameter

E/F: Approx. location of field stop

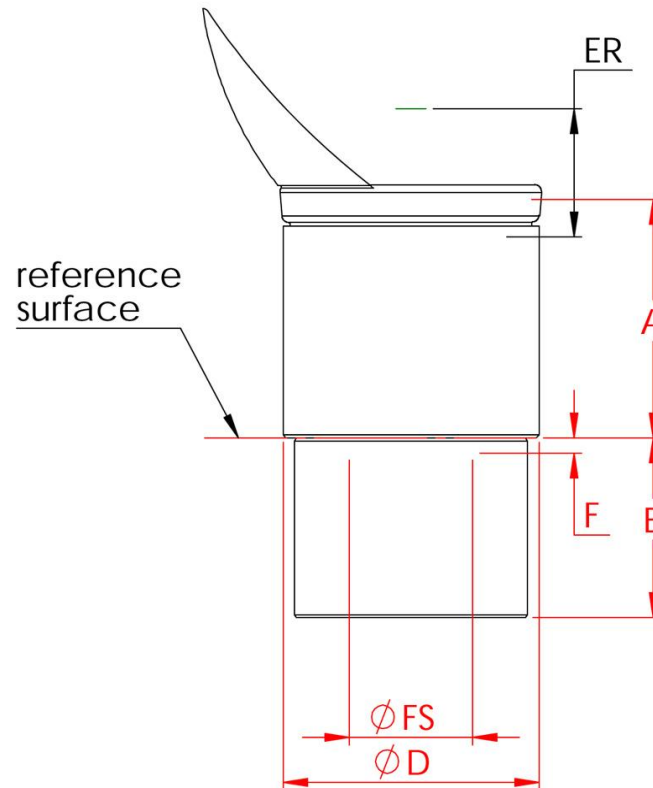

Note: The reference surface is not just the point where - on some eyepiece designs - the housing and barrel come together. Actually the reference plane is also the focal plane of the eyepiece and must be coincident with the image plane of the telescope in order to reach focus.