

Classic Ortho

Baader-No.	¹ FL (mm)	Eyepiece Type	Barrel (in.)	² E / G	³ AF	⁴ G	⁵ ER (mm)	Field Stop (mm)	⁷ Eyepiece Dimensions (mm)						Weight (g/lb/oz)
									A	B	C	D	E	F	
2954106	6	Classic Ortho	1¼"	4 / 2	52°	yes	5	5	10,20	24,00	-	34,80	-	2,00	37g
2954110	10	Classic Ortho	1¼"	4/2	52°	yes	8	8,7	17,12	24,00	-	34,80	-	2,00	48g
2954118	18	Classic Ortho	1¼"	4/2	52°	yes	14,7	16,8	30,46	24,00	-	34,80	-	2,00	81g
2954132	32	Classic Plössl	1¼"	4/2	50°	yes	21	26	54,80	24,00	-	34,80	-	2,00	94g

Table Notes

¹FL: Focal Length

²E / G: # Lens Elements / # Groups

³AF: Apparent Field of View

⁴G: Parfocal

⁵ER: Eye Relief

⁷Eyepiece Dimensions: see diagram

A: Height of barrel above reference surface

B: Height of 1¼" barrel

C: Height of 2" barrel

D: Outer Diameter

E/F: Approx. location of field stop

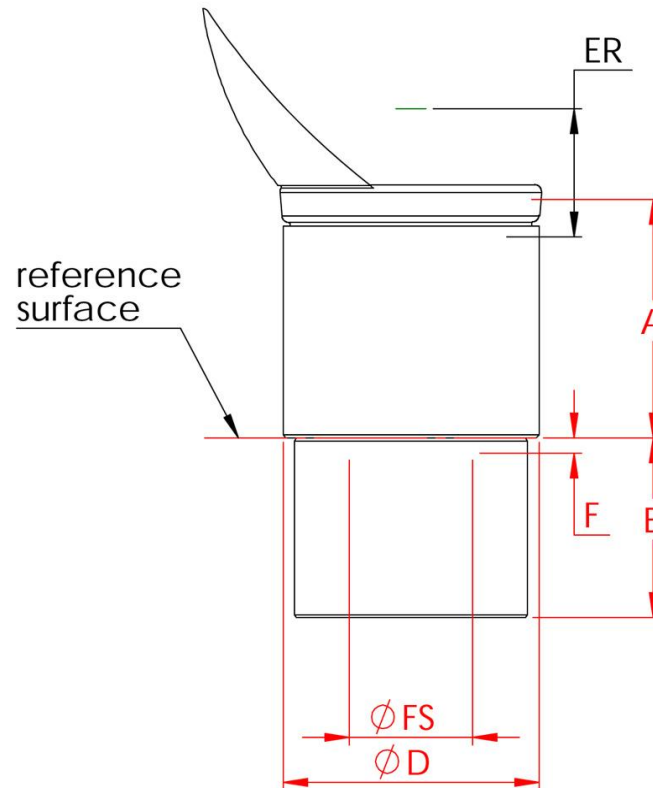

Note: The reference surface is not just the point where - on some eyepiece designs - the housing and barrel come together. Actually the reference plane must be coincident with the image plane of the telescope in order to reach focus.